

MASTER PLAN

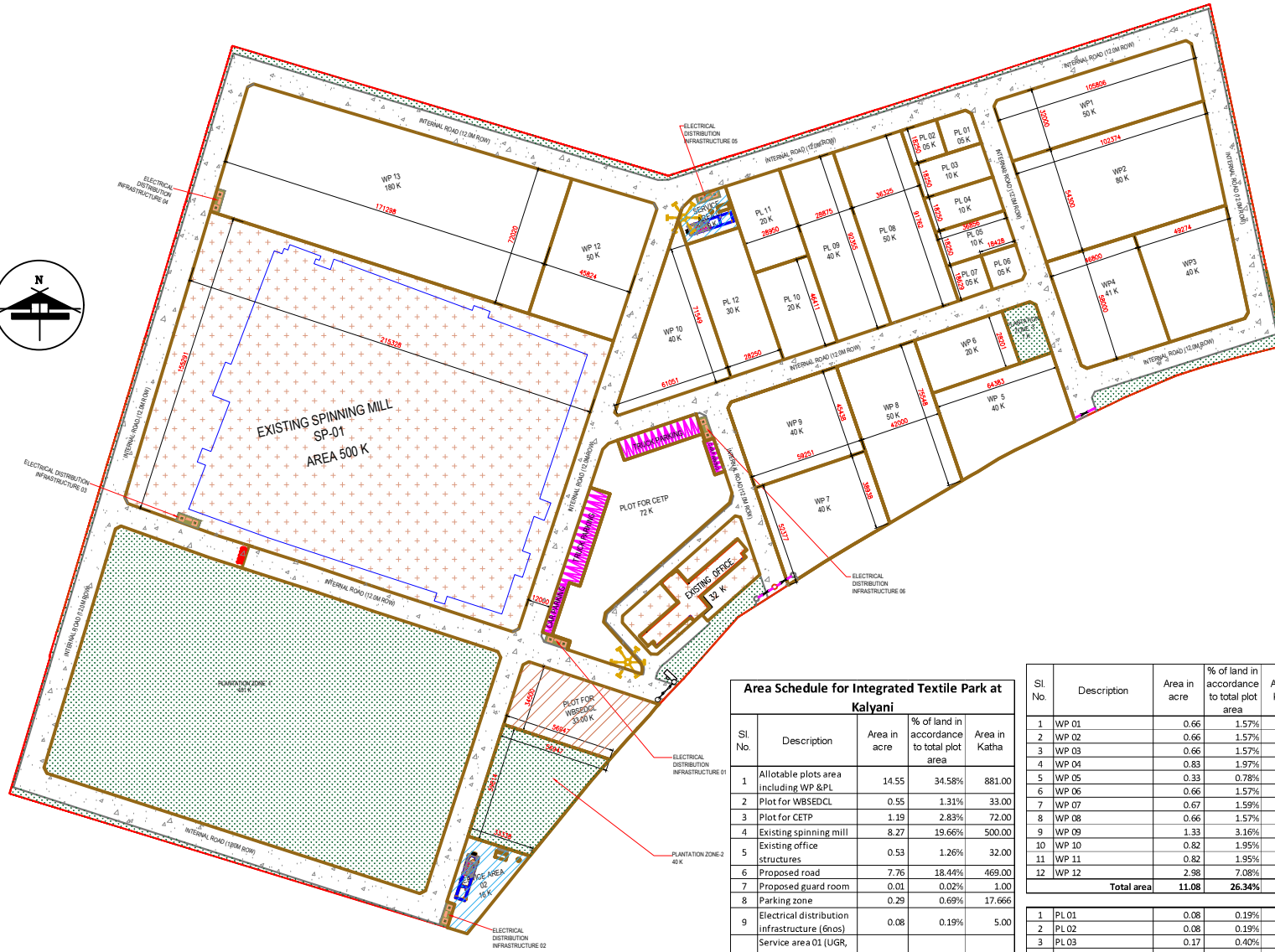

LEGEND:
 PL: POWER LOOM, GARMENTING, KNITTING
 WP: WET PROCESSING, DYEING, CALENDARING

Area Schedule for Integrated Textile Park at Kalyani

Sl. No.	Description	Area in acre	% of land in accordance to total plot area	Area in Katha
1	Allotable plots area including WP & PL	14.55	34.58%	881.00
2	Plot for WBSEDCL	0.55	1.31%	33.00
3	Plot for CETP	1.19	2.83%	72.00
4	Existing spinning mill	8.27	19.66%	500.00
5	Existing office structures	0.53	1.26%	32.00
6	Proposed road	7.76	18.44%	469.00
7	Proposed guard room	0.01	0.02%	1.00
8	Parking zone	0.29	0.69%	17.666
9	Electrical distribution infrastructure (6nos)	0.08	0.19%	5.00
10	Service area 01 (UGR, pump room, IR plant, Bore well)	0.15	0.36%	9.00
11	Service area 02 (UGR, pump room, IR plant, Bore well)	0.27	0.64%	16.00
12	Plantation zone 01	6.63	15.76%	401.00
13	Plantation zone 02	0.66	1.57%	40.00
14	Plantation zone 03	0.12	0.29%	7.00
15	Open & green space	1.01	2.40%	61.00
Total area		42.07	100.00%	2544.67

Sl. No.	Description	Area in acre	% of land in accordance to total plot area	Area in Katha
1	WP 01	0.66	1.57%	40.00
2	WP 02	0.66	1.57%	40.00
3	WP 03	0.66	1.57%	40.00
4	WP 04	0.83	1.97%	50.00
5	WP 05	0.33	0.78%	20.00
6	WP 06	0.66	1.57%	40.00
7	WP 07	0.67	1.59%	41.00
8	WP 08	0.66	1.57%	40.00
9	WP 09	1.33	3.16%	80.00
10	WP 10	0.82	1.95%	50.00
11	WP 11	0.82	1.95%	50.00
12	WP 12	2.98	7.08%	180.00
Total area		11.08	26.34%	671.00

1	PL 01	0.08	0.19%	5.00
2	PL 02	0.08	0.19%	5.00
3	PL 03	0.17	0.40%	10.00
4	PL 04	0.17	0.40%	10.00
5	PL 05	0.16	0.38%	10.00
6	PL 06	0.08	0.19%	5.00
7	PL 07	0.08	0.19%	5.00
8	PL 08	0.83	1.97%	50.00
9	PL 09	0.66	1.57%	40.00
10	PL 10	0.33	0.78%	20.00
11	PL 11	0.33	0.78%	20.00
12	PL 12	0.50	1.19%	30.00
Total area		3.47	8.25%	210.00

LAND SCHEDULE

Mouza	J.L. No.	Khatian No.	P.S.	District	L.R. Plot No.	Area
Kalyani	58	268	Chakdaha	Nada	9937	0.19
					9938	5.23
					9939	21.21
					9940	0.15
					9941	15.00
					Total	41.78

DATE	REV. NO.	REVISION	CHK. BY.	APPR. BY.

DRAWING NAME :-
 MASTER PLAN

PROJECT NAME :-
 INTEGRATED TEXTILE PARK AT KALYANI, WEST BENGAL

PROJECT CLIENT :-
 THE WEST BENGAL SMALL INDUSTRIES DEVELOPMENT CORPORATION LIMITED

CONSULTANT :-

 I - WIN Advisory Services Limited

DRAWING NO	IW/N/WSID/CM/PAKALY/01/R42		
REVISION NO	R42		
SCALE	1:1000	DRAWN BY	J.G.G. D.S.G.
DATE	14-09-2022	CHECKED BY	P.DAS APPROVED BY